

# BLACK EAGLE CONFERENCE CENTRE

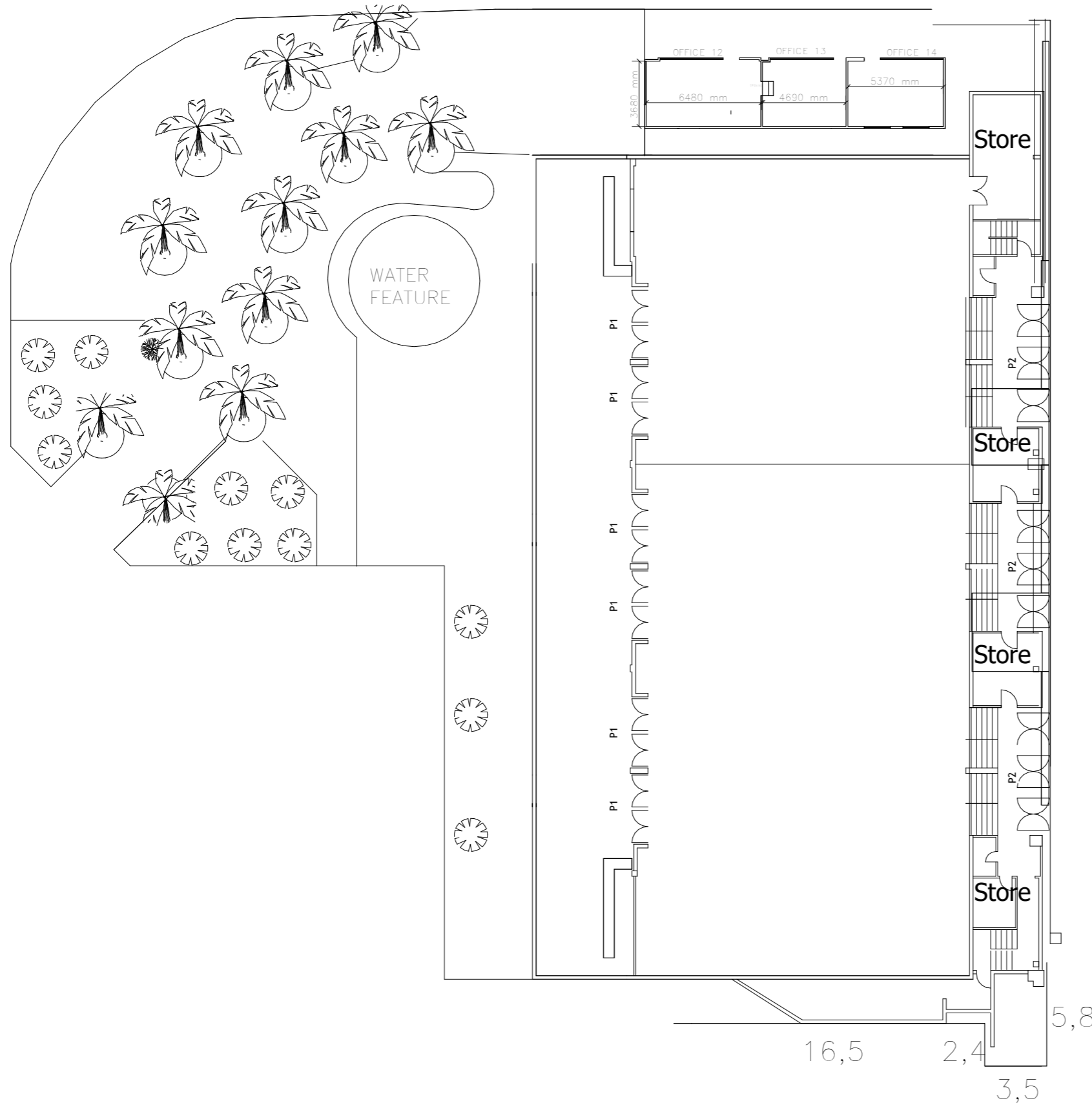

## DESCRIPTION:

- P1 - PUBLIC ENTRANCE  
FOYER TO CONFERENCE ROOMS
- P2 - PUBLIC ENTRANCE  
CONFERENCE ROOMS INTO HALL 6
- S2 - SERVICE DOOR  
H:1,890M W:1,480M
- GROSS AREA: 833 M<sup>2</sup>

## NOTE:

1. LIGHTING: FLOURESCENT WITH DIMMERS
2. PUBLIC ADDRESS AND CONFERENCE EQUIPMENT AVAILABLE ON REQUEST.
3. CEILING HEIGHT:  
CONFERENCE CENTRE - 4703 MM  
FOYER - 3012 MM
4. AIRCONDITIONED, CARPETED AND SOUND PROOFED

## LEGEND:

- FIRE HOSEREEL AND 2 FIRE EXTINGUISHERS
- FIRE HOSEREEL AND 1 FIRE EXTINGUISHER
- FIRE HOSEREEL
- FIRE EXTINGUISHER
- DISTRIBUTION BOARD

## SCALE:

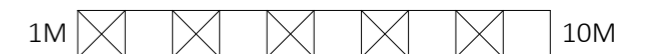

PLOTTED ON A3: 1:275

1 STAND LAYOUT  
1 : 275